



Rowan Court, Cowper Close, Ware SG12 0GJ

£110,000 40% Share of Total Value



1



1

Taylor Phelps

Estate Agency

Taylor Phelps

Estate Agency

Representing a 40% share of the total value, Taylor Phelps are pleased to offer this superb one bedroom apartment positioned within this modern, recently built development in Ware! This fantastic top / second floor apartment benefits from bright and spacious accommodation throughout, a modern kitchen and bathroom, private balcony from the living room, a long lease and residents parking!





Taylor Phelps



Taylor Phelps



Taylor Phelps



Taylor Phelps

Floor Plan

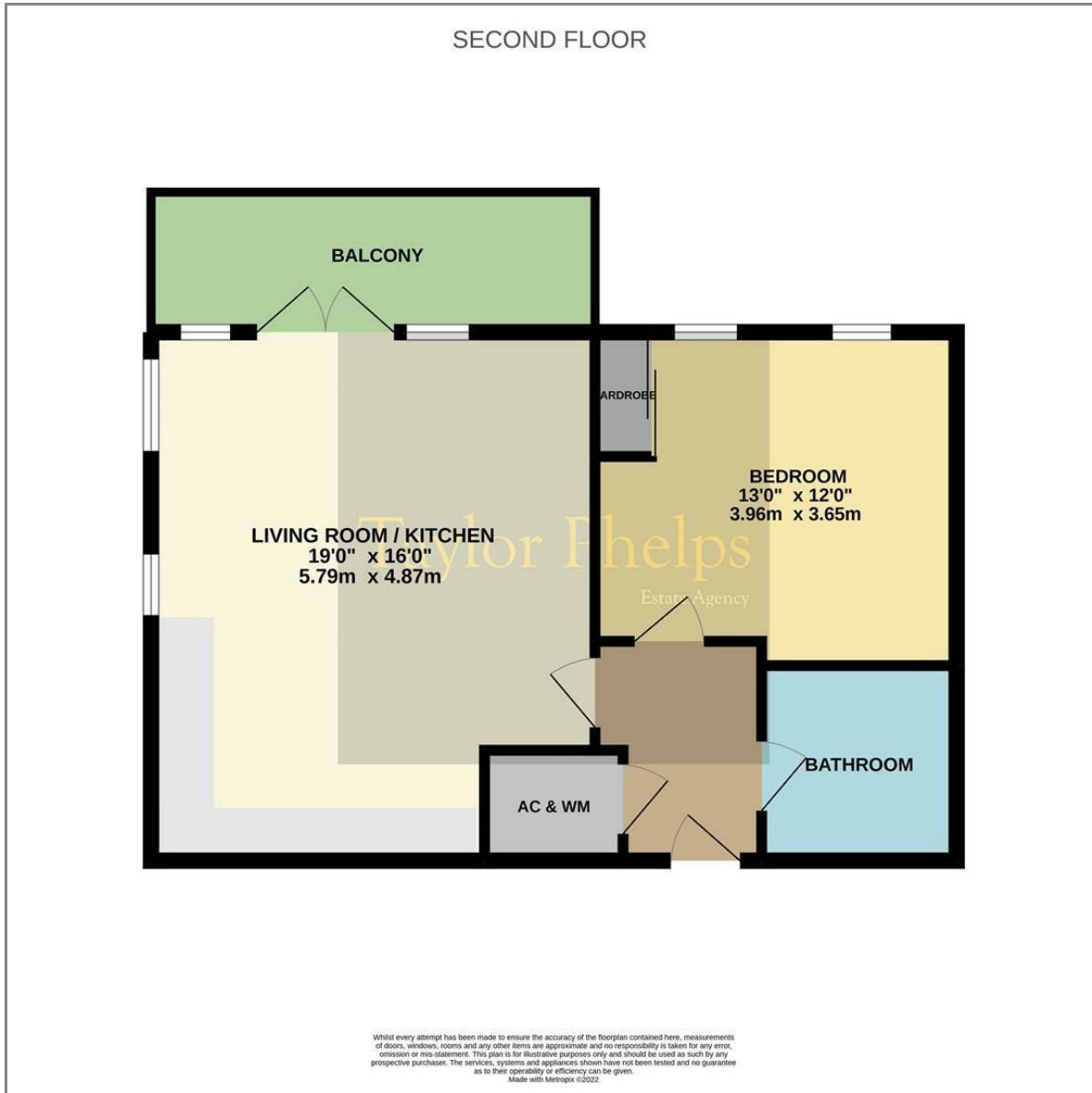

Area Map

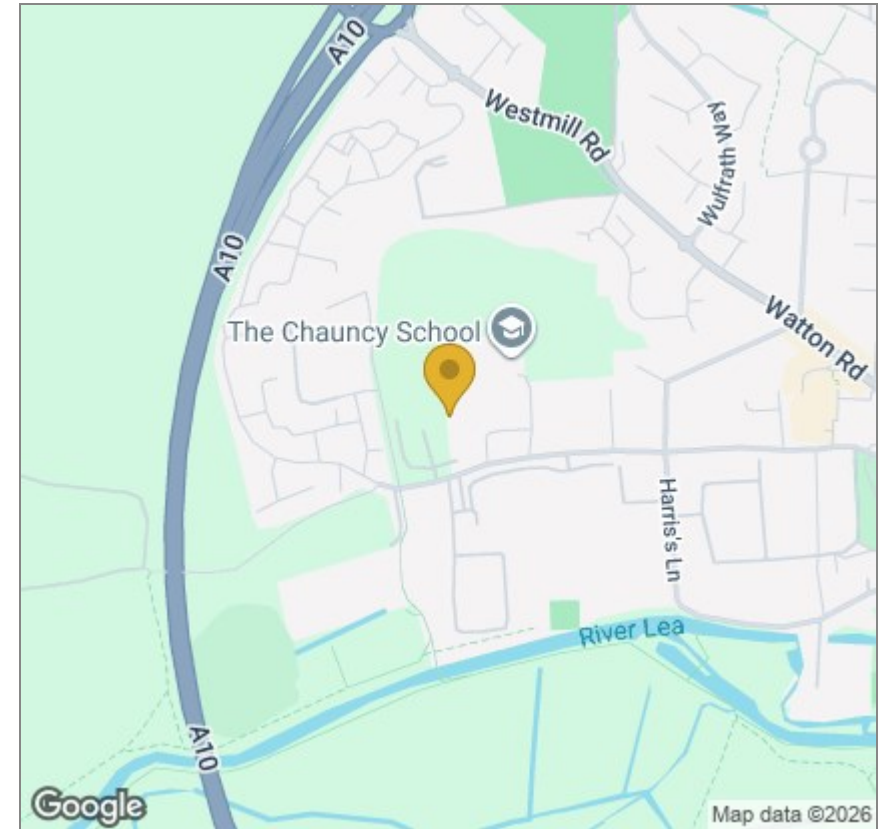

Energy Efficiency Graph

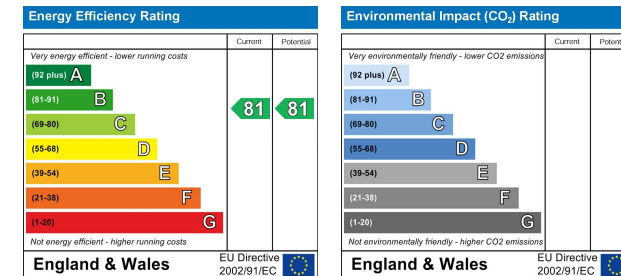

These particulars, whilst believed to be accurate are set out as a general outline only for guidance and do not constitute any part of an offer or contract. Intending purchasers should not rely on them as statements of representation of fact, but must satisfy themselves by inspection or otherwise as to their accuracy. No person in this firm's employment has the authority to make or give any representation or warranty in respect of the property.

01920 459000

hello@taylorhelps.co.uk

5 Frenchs Yard, Amwell End, Ware, Hertfordshire, SG12 9HP

www.taylorhelps.co.uk

